

## CAYMAN BRAC LOGHOUSE DRIVE 2.74 ACRES

Cayman Brac East, Cayman Islands

MLS# 419632

**CI\$199,000**

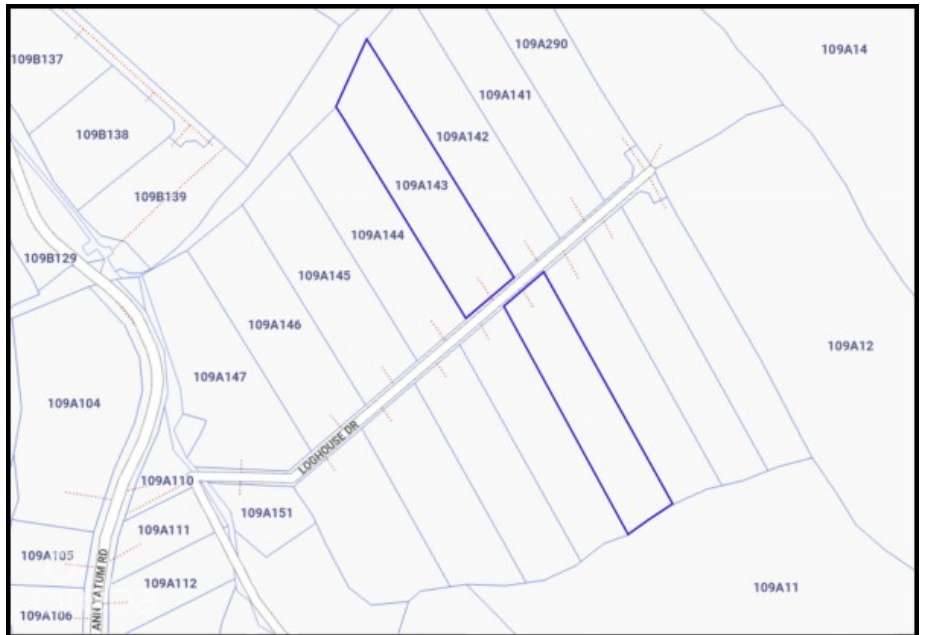

**Carolyn Ritch**

carolyn@ritchrealty.ky

Situated on the coveted Bluff Edge of Cayman Brac's peaceful Eastern side, this rare 2.74-acre parcel offers exceptional privacy and captivating beauty. Perched over 110 feet above sea level, the property commands breathtaking, uninterrupted views of the shimmering Caribbean Sea. Its elevated position captures cooling breezes and showcases some of the island's most spectacular sunsets. With its expansive size, seclusion, and sought-after Bluff Edge location, this is the perfect site for a private estate, luxury villa, or investment in one of the Cayman Islands' most dramatic landscapes.

## Essential Information

Type  
**Land (For Sale)**

Status  
**Current**

MLS  
**419632**

Listing Type  
**Agriculture**

Key Details

Width	Depth	Bed	Bath	Block & Parcel
230.00	1025.00	0	0	109A,143
Acreage				
2.7400				
Den	Sq.Ft.			
No	0.00			

Additional Feature

Views	Zoning	Road Frontage	Soil
Water View	Agriculture/Residential	230	Rock