

## 34 ACRES EAST END

East Interior, Cayman Islands

MLS# 420729

**CI\$3,927,000**

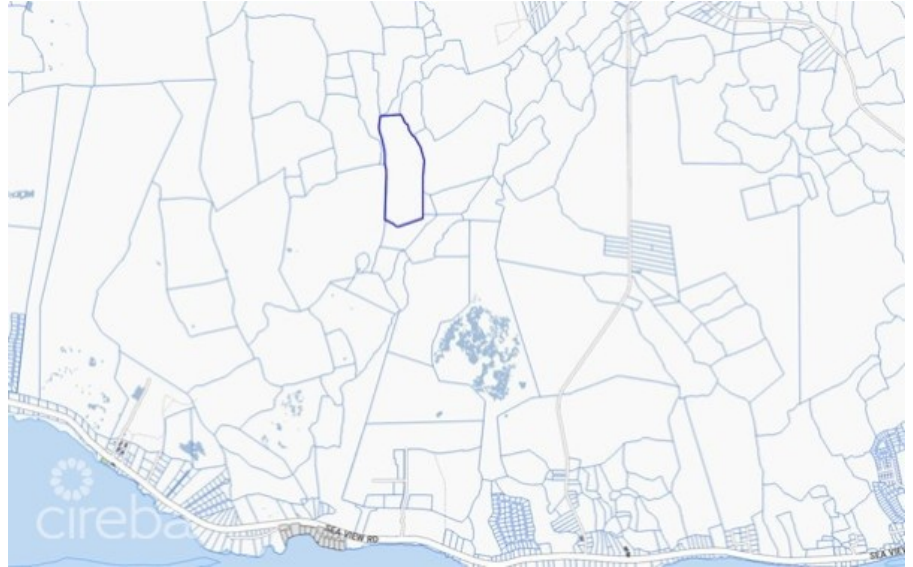

**Carolyn Ritch**  
carolyn@ritchrealty.ky

Positioned in the heart of East End, this remarkable 34-acre parcel presents a rare chance to secure a substantial tract of land in one of Cayman’s most up-and-coming areas. With a 30-foot road access already paid for and supporting documentation in place, much of the heavy lifting has been done—offering a clear path for future development. This is truly a developer’s dream, with ample space and flexibility to bring a wide range of visions to life. Whether you’re considering a residential community, private estate, or a long-term investment hold, the possibilities here are endless. The land also lends itself exceptionally well to farming or agricultural use, making it equally attractive for those seeking a more sustainable or income-producing venture. Large parcels with this level of potential, accessibility, and value—just under \$4 million—are becoming increasingly hard to find in East End. An opportunity like this doesn’t come around often.

### Essential Information

|                        |                |               |                    |
|------------------------|----------------|---------------|--------------------|
| Type                   | Status         | MLS           | Listing Type       |
| <b>Land (For Sale)</b> | <b>Current</b> | <b>420729</b> | <b>Agriculture</b> |

### Key Details

|                           |                         |                 |                  |                                 |
|---------------------------|-------------------------|-----------------|------------------|---------------------------------|
| Width<br><b>755.79</b>    | Depth<br><b>2166.72</b> | Bed<br><b>0</b> | Bath<br><b>0</b> | Block & Parcel<br><b>63A,47</b> |
| Acreage<br><b>34.0000</b> |                         |                 |                  |                                 |
| Den<br><b>No</b>          | Sq.Ft.<br><b>0.00</b>   |                 |                  |                                 |

## **Additional Feature**

Views  
**Inland**