

HUTLAND HOUSE LOT

North Side, Cayman Islands

MLS# 416417

CI\$109,000

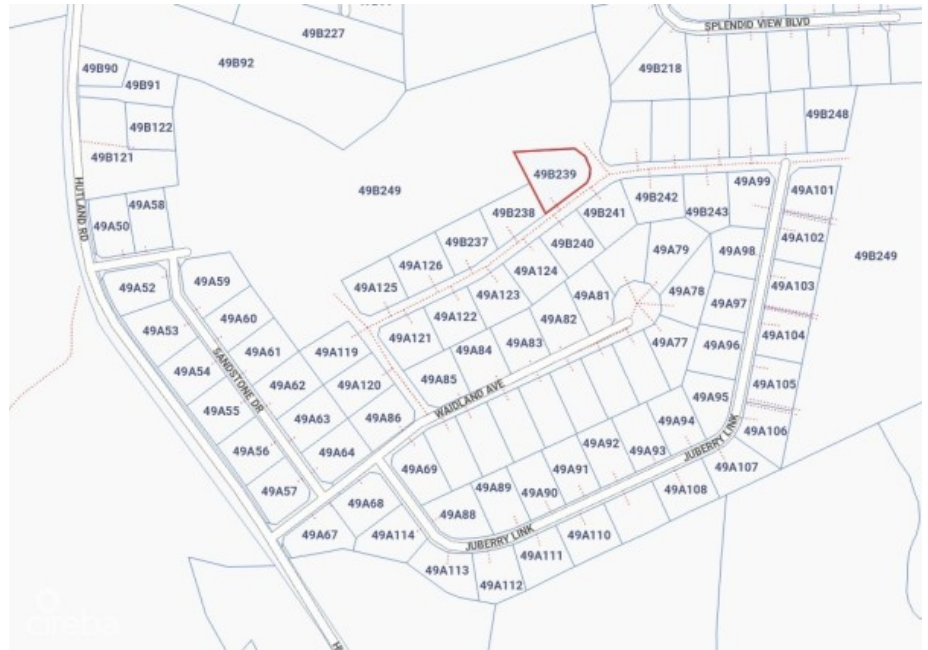



Carolyn Ritch
carolyn@ritchrealty.ky

Welcome to this enchanting residential house lot located in the serene and picturesque neighbourhood of Hutland North Side. Spanning approximately 0.3031 acres, this property offers an idyllic setting for building your dream home in a tranquil and welcoming community. The generous lot size provides ample space to create a comfortable and harmonious living environment, allowing you to design and construct a spacious residence with room for gardens, outdoor recreation areas, or even a pool. The property comes partially filled, providing a head start for your construction plans and saving you valuable time and resources. Additionally, the main road leading to the property has been paved with Asphalt, ensuring smooth and easy access. Hutland North Side is known for its peaceful ambiance and friendly neighbourhood, offering a safe and secure environment for families and individuals alike. Whether you are looking to build your forever home or seeking a sound real estate investment, this property presents an excellent opportunity for future value appreciation. Embrace the chance to create your own piece of paradise in Hutland North Side. Contact us today to schedule a viewing and start planning your future in this charming neighbourhood.

Essential Information

| | | | |
|-----------------|---------|--------|-------------------------|
| Type | Status | MLS | Listing Type |
| Land (For Sale) | Current | 416417 | Med Density Residential |

Key Details

| | | | | |
|---------|--------|-----|------|----------------|
| Width | Depth | Bed | Bath | Block & Parcel |
| 126.00 | 145.00 | 0 | 0 | 49B,239 |
| Acreage | | | | |
| 0.3031 | | | | |
| Den | Sq.Ft. | | | |
| No | 0.00 | | | |

Additional Feature

| | | | |
|--------|----------------------------|---------------|------|
| Views | Zoning | Road Frontage | Soil |
| Inland | Medium Density Residential | 111 | Marl |